

Nova

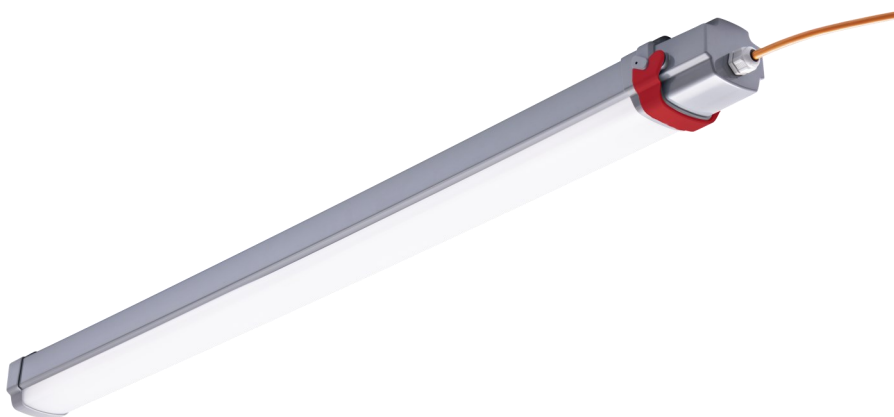

KEY BENEFITS

- Modular design for up to 2 sizes.
- Electronics and replaceable joints, built to last.
- Combines the best features of extrusion and injection luminaires, offering high durability and complete adaptability.
- Robust for a wide range of temperatures, up to 55°C.
- Quick and secure connection with up to 8 poles ready for wiring through, phase connection, emergency, etc.
- Innovative lever locking system for fast and secure assembly, prepared for vandalism-proof environments.
- Durability and sturdiness: IP66/69K + IK10
- State-of-the-art LED technology.
- Energy Efficient: 156lm/W
- 3 types of fixation.
- Up to 3 optical distributions.
- Lifetime L80B50 100.000 to 35°C.
- 3-hour emergency functionality.
- Option with sensor.
- Continuous line mounting option.
- 5 years warranty



DESCRIPTION

Nova stands out for its durability, modularity, and flexibility, allowing the incorporation of future digital technologies. With various options for length, light packages, optics, and connectivity, Nova adapts to specific needs and promotes durability in demanding environments, with the possibility of fully opening up for component replacement. It offers in-line connection for up to 15 units, with pass-through wiring for up to 5 cables and a locking system between profiles. Additionally, it has the ability to integrate additional solutions to enhance energy efficiency, such as wireless connectivity and presence and daylight sensors.

STANDARD COMPLIANCE

- EN-60598-1
- EN 60598-2-24
- EN-62031
- EN-61000-3-2
- EN-61547
- EN-60598-2-1
- EN-62262
- EN-55015
- EN-61000-3-3
- EN-62471



4000K
Ra>80



S: 4.000lm
M: 6.000lm - 10.000lm



-40°C a + 55°C



156lm/W



S: 2,9 Kg - 3,1 Kg
M: 3,6 Kg - 3,8 Kg

220-240V- 50/60HZ
L80B50 100.000 a 35°C

PHOTOMETRIC DISTRIBUTIONS

It has the 3 photometrics distributions used for the environments in which this type of luminaire is installed, allows it to adapt to all needs:

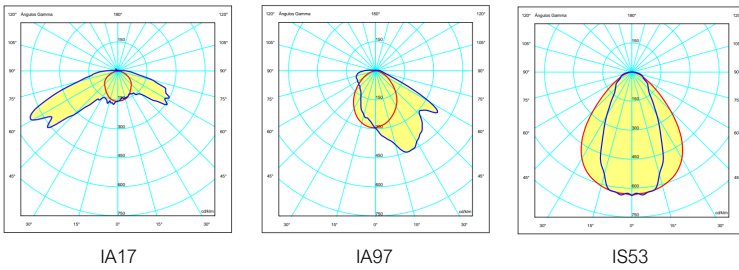

DIMENSIONS



Model	X	Y	Z
S	1.372	117	95
M	1.664	117	95

APPLICATIONS

Food industry, cold rooms, automotive industry, corridors and warehouse, convention centre and exhibitions spaces



NOVA CHARACTERISTICS

GENERAL CHARACTERISTICS

Profile	Extruded polycarbonate with UV protection Upper part dark grey RAL 7046
End caps	Injected polycarbonate
Gasket	Removable and recyclable thermoplastic elastomers
Gear tray	White lacquered steel plate
Cable entry	Cable gland (M20 or M25)
Finition	RAL-7046 Telegrey 2 glossy smooth
Watertightness	IP66/ 69K (EN 60598-1 to EN 60598-2-3)
Impact protection grade	IK10 (EN 62262)
Operating temperature	-40°C to 55°C
Lifetime	L80B50 100.000 a 35°C.

ELECTRICAL CHARACTERISTICS

Electrical class	Class I
Voltage / Frequency	220-240V- 50/60HZ
Power factor	>0.95 at full power.
Fire protection	Flammability (UL94): V2 Glow wire test (EN 60595-2-11): 850°C
Connection	3 to 8 poles WAGO quick connector
THD	10%
Flicker factor	<1%

LIGHTING CHARACTERISTICS

Package real light	S: 4.000lm (26W) M: 6.000lm - 10.000lm (41W - 64W)
LED colour temperature	4.000K (Neutral White, nw). Optionally amber color temperature.
Index of reproduction chromatic (CRI)	CRI>80.
Optics	PMMA polymethylmethacrylate.
Emergency	3h.

MAINTENANCE AND ASSEMBLY

Installation and maintenance	Installation for indoor or outdoor use. The luminaire and cover design allows easy access to the tray, enabling the replacement of its electronic components, such as emergency batteries.
Continuous line lighting units (on request)	It is possible to connect up to 15 lighting units in a line, thanks to its pass-through wiring with up to 5 cables, suitable for dimmable versions, and the easy and fast locking system between profiles.
Accessories	Suspension cable Anti-theft protection Mounting accessory Fixing clips
Fixation	Ceiling fixation Suspended fixation Wall fixation
Weight	S: 2,9 Kg - 3,1 Kg M: 3,6 Kg - 3,8 Kg

MANAGEMENT AND CONTROL

Equipment	1N: 1 Level RD: DALI
-----------	-------------------------

ACCESSORIES

Mounting accessories



Suspension wire 2m hook and fastener, 1 unit



Theft protection (required for wall fixation), set for 1 luminaire



ZBWM wall fixation accessory (allows luminaire rotation), 2 pieces set

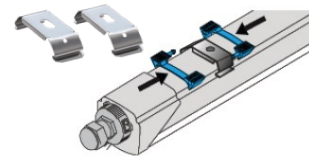

Fixing clips in stainless steel 316L, 2 units

MODULARITY (on request)

Up to 15 luminaires can be connected in one line.

Modularity facilitates the replacement of components, such as emergency batteries, as well as continuous in-line connection. Additionally, the lever-locking system ensures security and resistance to vandalism, with the additional option of using a security screw.

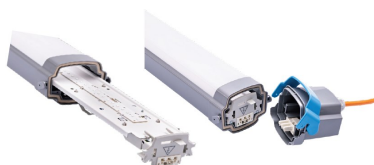

Distributor: EPK elektro s.r.o.
info@carandini.cz - www.carandini.cz